

INSTALLATION GUIDE

ODOCAN^{MC}



IMPORTANT

Before proceeding with the system installation,
Be sure to have carefully read and understood all instructions provided in this guide.

WARNING

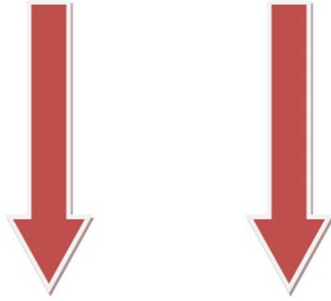

IMPORTANT

This document provides all necessary instructions for the adequate and secure installation of your **ODOCAN^{MC}** system.

Before proceeding with the installation or configuration of the **ODOCAN^{MC}** system, the technician installer must have read and understood the instructions provided in this guide.

This document includes important indications to prevent serious injuries both to the technician installer and to the users.

The **ODOCAN^{MC}** system made by Zone Technologie Électronique Inc. is fully programmable (all settings are flexible).

TABLE OF CONTENTS

General description	1
Essential connection	1
Technical specifications	1
Installation	2
Warning.....	2
Mechanical installation	2
Electrical installation.....	2
Module installation.....	3
Connection diagram	4
Caravan	4
Escape Hybrid.....	5
Dakota.....	6
Colorado	7

GENERAL DESCRIPTION

The **ODOCAN^{MC}** system allows you to calculate the total distance traveled with a vehicle. Furthermore, it offers the possibility to record until 99 reference points (intermediary distances) during the travel.

The total distance and the reference points which were recorded can be consulted from the module. These data are kept in the memory until a new acquisition (new travel) has begun.

ESSENTIAL CONNECTIONS

One advantage of the **ODOCAN^{MC}** system is its simple installation that only requires two connections to make it work properly:

- 1) One OBD2 cable which connects the vehicle OBD2 connector to the ODOCAN-auxiliary module.
- 2) One flat cable which connects the ODOCAN-auxiliary module to the **ODOCAN^{MC}** module.

NOTE: To decrease the distance when the vehicle is in reverse gear, you must connect the reverse gear signal to the ODOCAN-auxiliary module (see p.3: Installation diagram).

TECHNICAL SPECIFICATIONS

Supply voltage: 10 à 16Vcc

Operating temperature: -20°C à 75°C (-4°F à 167°F)

Supply current: - System OFF: 4mA
 - System ON (No load): 175mA

Output: - « Beacon » (ODOCAN- auxiliary): 12V, 10A

Input: - « RVERSE » (ODOCAN- auxiliary): 12V, 10mA

INSTALLATION

ODOCAN^{MC} MODULE

WARNING

Pay particular attention to the safety and installation instructions in this guide to prevent damage to the unit or vehicle as well as serious injuries to anyone working on the vehicle, occupants or you.

The installation technician should have a good understanding of vehicular electrical and electronic systems to perform a compliant and safe installation.

To make this product works with maximum efficiency, protect all electrical and mechanical components according to standards.

Once the installation is completed, make sure the proper functioning of the system and all accessories in the vehicle.

MECHANICAL INSTALLATION

Installation of the ODOCANMC Module

During the installation, be sure that the module cannot be damaged because of unsafely objects being in the vehicle and that the chosen location won't be subject to bad weather.

The module must be installed in the vehicle passenger compartment or in a waterproof case.

The module is designed to tolerate a weather margin which varies from -20°C to 75°C (-4°F to 167°F).

There are many ways to fix the module; the technician must consult the user to answer his needs in the best way he can. It is highly recommended to fix it so it will be accessible by the user at any time and in all conditions of operation.

Be sure that the module is fixed in a way that it won't move when a key is pressed on.

WARNING : Make sure the keyboard clears the space for the deployment of all airbags.

ELECTRICAL INSTALLATION

Make all the necessities connections so that the system and its components will be functioning. Install all the electric protection (fuse, breaker, fuse wire) on the power cord as close as possible of the alimentation source. All wires going through a partition must be protected by a rubber or plastic washer.

Be sure to follow all instructions included in this guide.

CAUTION : Before installation, disconnect the negative of the vehicle's battery. Failure to follow the recommendations found in this guide could result in fire or injury.

Please wait until all electrical connections are completed and checked before reconnecting the battery negative.

MODULE INSTALLATION

The ODOCAN^{MC} module installation is always performed in the same way, whatever the vehicle. However, the connection of the « REVERSE » signal varies according to the vehicle model.

- 1) Plug the OBD2 cable in the OBD2 vehicle outlet;
- 2) Fix the OBD2 replacement outlet,
- 3) Plug the DB9 connector of the OBD2 cable in the ODOCAN-auxiliary module
- 4) Plug the flat cable (grey) on the ODOCAN-auxiliary module to the ODOCAN^{MC} module.
- 5) Plug the « REVERSE » gear signal of the vehicle on position #6 on the ODOCAN-auxiliary module.

Installation Diagram ODOCAN

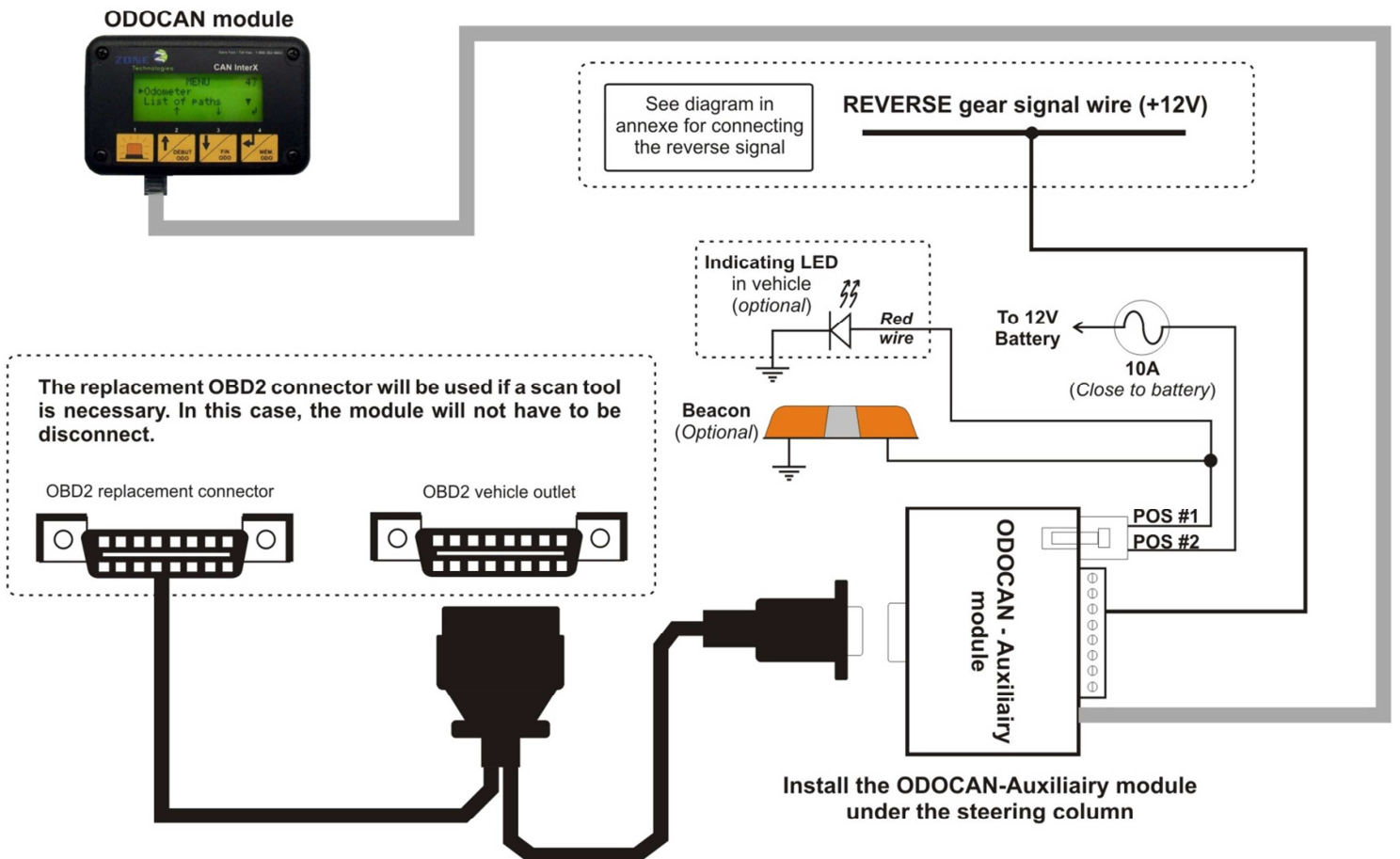

CONNECTION DIAGRAM

CARAVAN

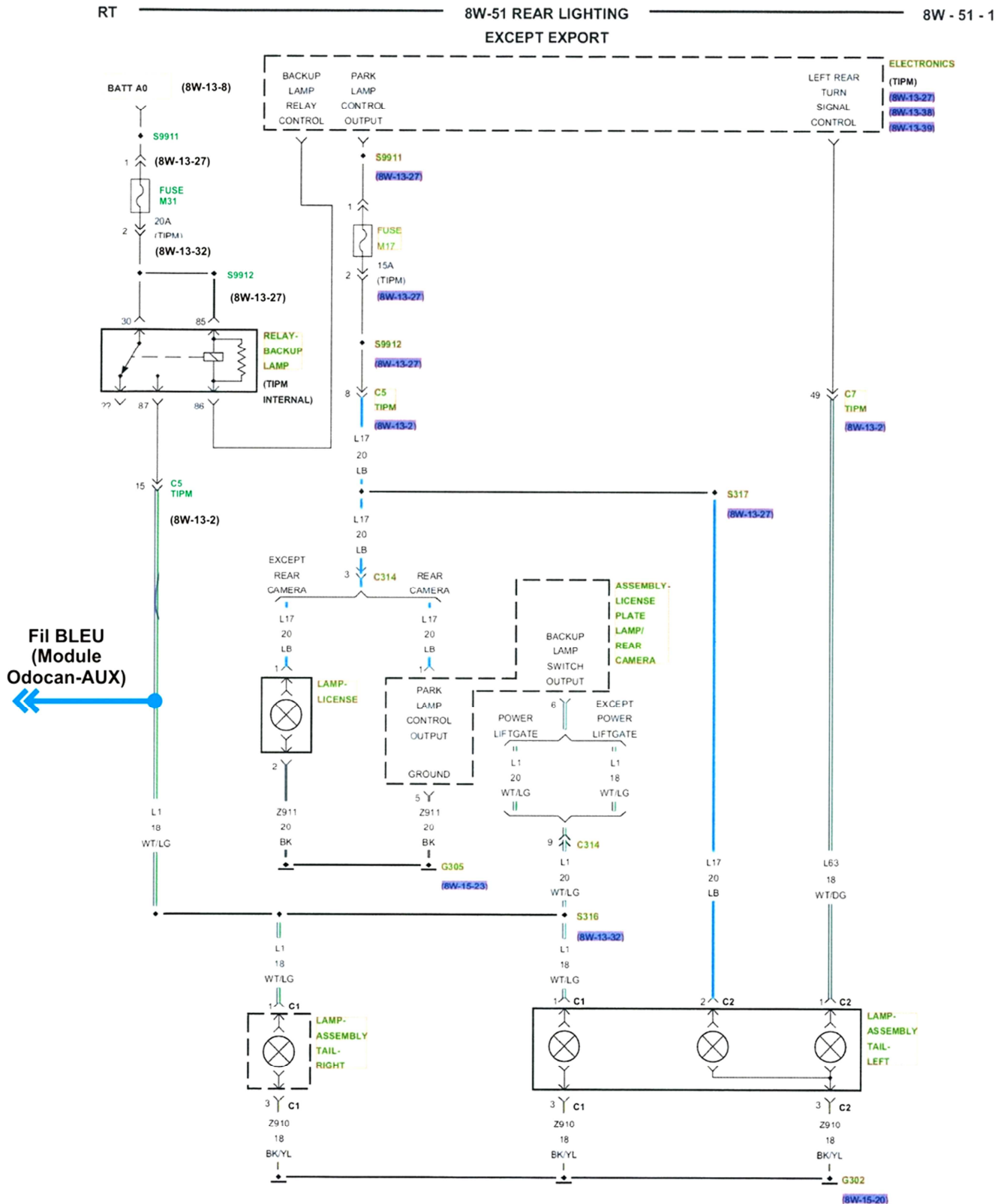

ESCAPE HYBRID

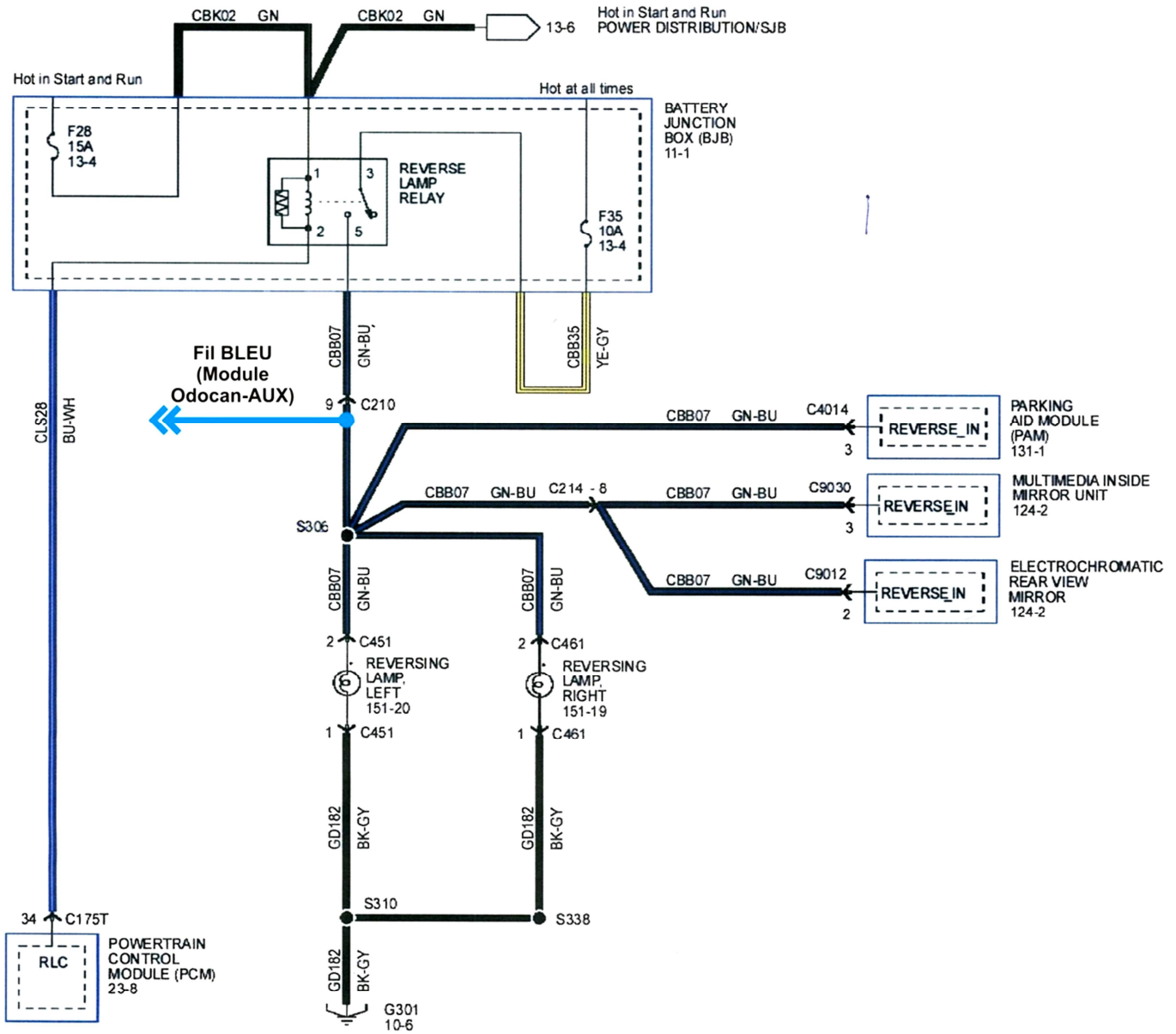

DAKOTA

8W - 51 - 4

8W-51 REAR LIGHTING

ND

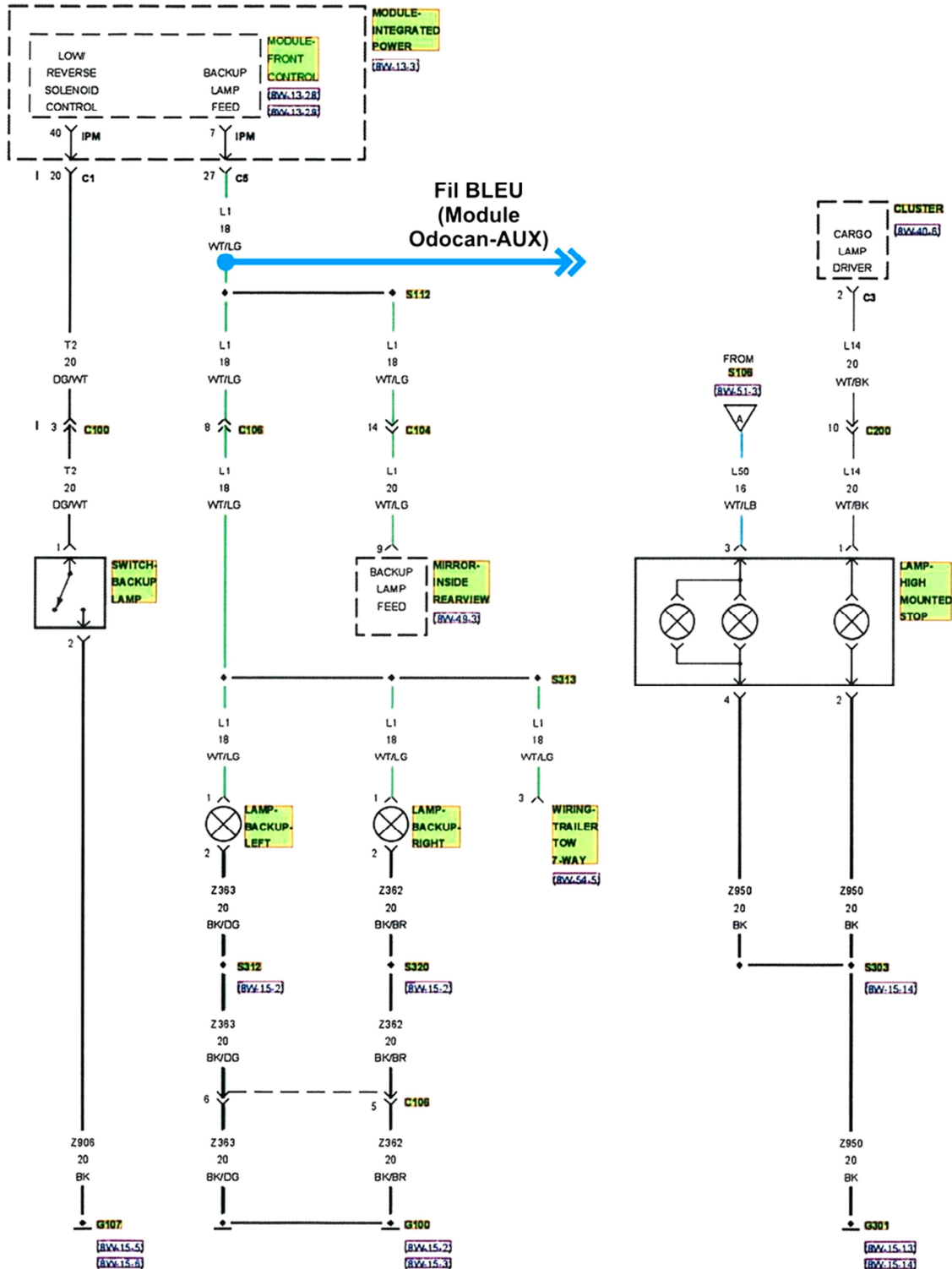

COLORADO

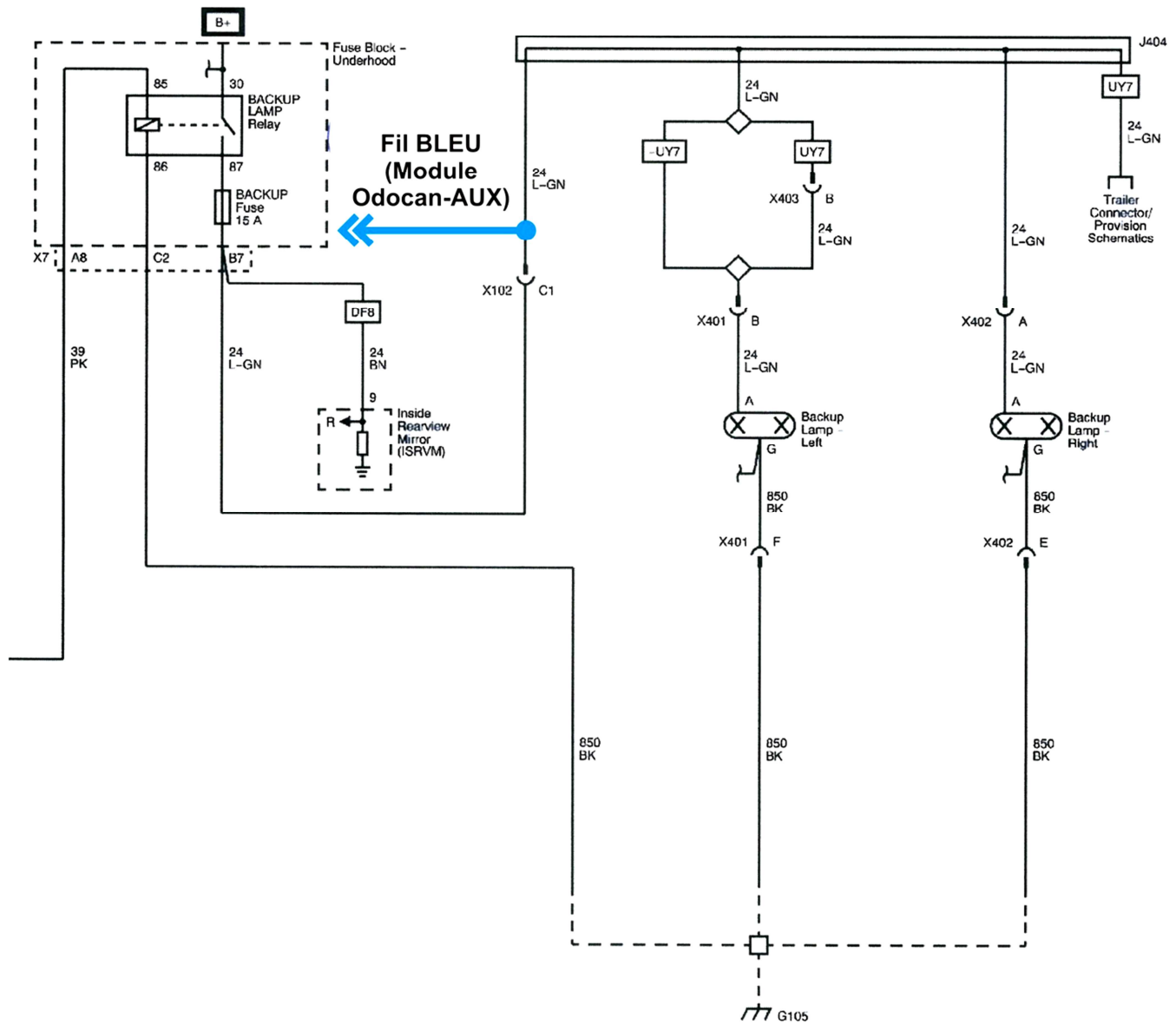

[illegible]

Zone Technologie Électronique Inc. guarantees every component that it produces for a period of 24 months starting on the date of the purchase or of the delivery. The products of Zone Technologie Électronique Inc are verified, inspected and recognize as exempt of any fabrication default.

If a product is found to be defective during the warranty period of 24 months, the product will be repaired or replace at the workshop of the Zone Technologie Électronique Inc. society.

All installation, using or modification of the Zone Technologie Électronique Inc. products which is not recommended by the manufacturer leads to a voiding of the actual warranty.

Zone Technologie Électronique Inc. can't be held liable for the damages or charges that arise because of misuse, a careless maneuver or any others attempts to repair or for any reparations made by a third party. No other warranty, written or verbal, than the one from Zone Technologie Électronique Inc. will be recognized.

Zone Technologie Électronique Inc also has the right to repair or replace any defective product to its sole discretion. Zone Technologie Électronique Inc can't be held liable for the charges that arise during the installation or the removal of a product that requires maintenance and/or repairing.

It is expressly specified that we shall be committed by no other warranty (express or tacit) of intrinsic quality, marketable quality or capacity in a particular use.

For any information, please don't hesitate to communicate with us.
Phone number: 450-572-1476 • 1-866-362-9663 • Fax: 450-572-0898

Zone Technologie Électronique Inc. reserves the right to bring changes to this document and/or product included, without notice, and this at any moment.

Zone Technologie Électronique Inc. can't be held liable regarding any possible mistakes and/or omissions in this document

ZONE

Technologie Électronique Inc.

Toll free : 1 866 362-9663

Phone : 450 572-1476

Technical support

Extension #205

Administration

Extension #221

Fax : 450 572-0898

9000, boul. Industriel, Chambly (Québec) J3L 4X3